

**MAP 1
NORTH SERVICE ROAD CLOSURE, TRANS-CANADA HIGHWAY 1 NEAR WHITE CITY
TARGETTED TO BEGIN TUESDAY, MAY 10, 2016**

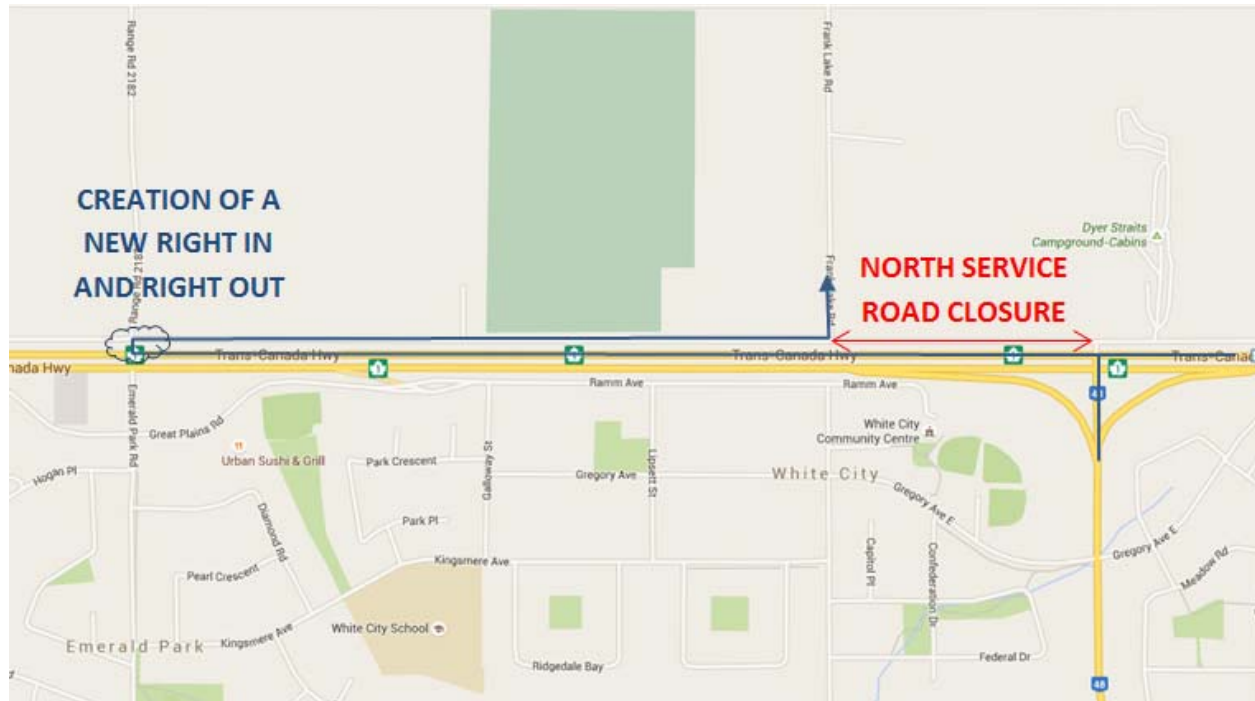

- A portion of the North Service Road from Trans-Canada Highway 1 to Frank Lake Road will be closed.
- To access Frank Lake Road, motorists can use Highway 1 west to make a right turn at the new right in / right out on the north side of Emerald Park, as indicated in the blue arrows in the above diagram.

**MAP 2
SOUTH SIDE OF TRANS-CANADA HIGHWAY 1 NEAR WHITE CITY
TARGETTED TO BEGIN TUESDAY, MAY 10, 2016**

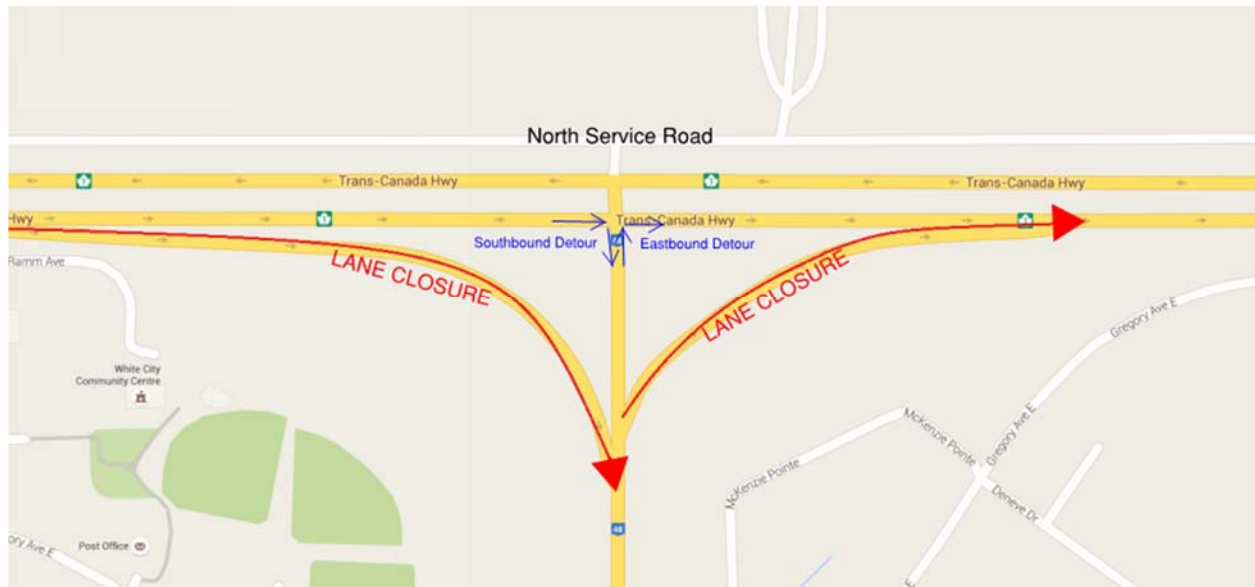

- Access from the Trans-Canada Highway 1 onto the exit ramp heading south into White City onto highway 48 and the exit ramp leaving White City on Highway 48 heading eastbound onto the Trans-Canada Highway 1 will be prohibited, as indicated in the above diagram in red.
- Trans-Canada Highway 1 motorists heading south into White City will be required to make a right turn southbound at Highway 48. Northbound motorists heading eastbound onto Trans-Canada Highway 1 will be required to make a left turn at the intersection, as indicated in the blue arrows in the above diagram.